



# PIPE HANDLING & HOISTING

**MINERAL EXPLORATION  
ENVIRONMENTAL  
GEOTECHNICAL  
GEOTHERMAL  
ROTARY  
SONIC  
HDD**



[www.holeproducts.com](http://www.holeproducts.com)

# PIPE HANDLING & HOISTING

## TABLE OF CONTENTS

**PIPE HANDLING & HOISTING OVERVIEW ..... 3**

**HOISTING PLUGS .....4-7**

**PIPE HANDLING & HOISTING .....8-11**

- Pipe & PVC Elevators ..... 8
- Casing Lifters ..... 9
- Pipe Tongs ..... 9
- Auger Hoisting Caps ..... 9
- Lift Rings ..... 10
- Hooks ..... 10
- Kwik Klamps™ ..... 11

**WRENCHES .....12-14**

- Pipe Wrenches ..... 12-13
- Chain Wrenches & Petol® Tongs..... 14





## PIPE HANDLING AND HOISTING



Hole Products offers a full range of pipe handling and hoisting equipment including hoisting plugs, pipe and casing elevators, casing lifters, pipe tongs, lift rings, slip rings, safety hooks, Kwik Klamps, and more.

Pipe handling and hoisting equipment is available in a variety of sizes and styles to fit any project requirement.

All pipe handling and hoisting equipment is constructed of top quality components, which provide superior reliability and help to ensure safe raising and lowering of drill tools.

Please contact your Hole Products representative for detailed product information and availability of additional pipe handling and hoisting plugs.

*Products listed in the catalog are representative of the most common industry sizes and styles. Please contact your Hole Products representative for additional product offerings.*

# HOISTING PLUGS

## AW HOISTING PLUG

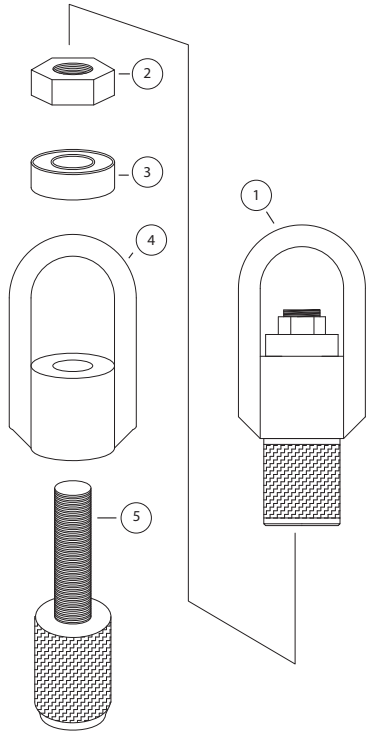

AW BOX HOISTING PLUG CAPACITY		
SIZE	ROTATING	STATIC
AW	12,200 lbs. / 5,533 kg	29,400 lbs. / 13,335 kg

AW BOX HOISTING PLUG		
ITEM	PART #	DESCRIPTION
1	5050000	HOISTING PLUG ASSEMBLY
2	5050050	NUT
3	5050055	BEARING ASSEMBLY
4	5050060	BAIL
5	5050100	SPINDLE ASSEMBLY

## NW HOISTING PLUG

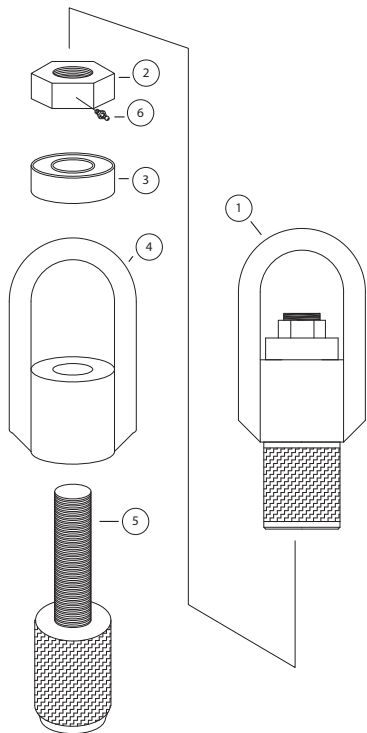

NW BOX HOISTING PLUG CAPACITY		
SIZE	ROTATING	STATIC
NW	21,400 lbs. / 9,707 kg	43,600 lbs. / 19,777 kg

NW BOX HOISTING PLUG		
ITEM	PART #	DESCRIPTION
1	5050007	HOISTING PLUG ASSEMBLY
2	5050070	NUT
3	5050075	BEARING ASSEMBLY
4	5050080	BAIL
5	5050105	SPINDLE ASSEMBLY
6	5050090	LOCKING SET SCREW

# HOISTING PLUGS

## AWJ HOISTING PLUG

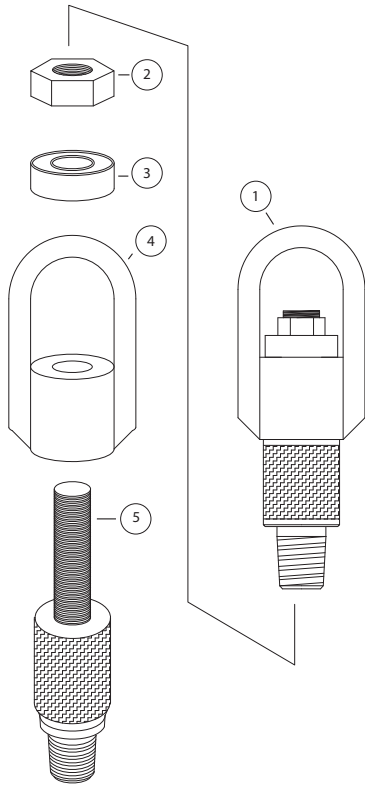

AWJ PIN HOISTING PLUG CAPACITY		
SIZE	ROTATING	STATIC
AWJ	12,200 lbs. / 5,533 kg	29,400 lbs. / 13,335 kg

AWJ PIN HOISTING PLUG		
ITEM	PART #	DESCRIPTION
1	5050005	HOISTING PLUG ASSEMBLY
2	5050050	NUT
3	5050055	BEARING ASSEMBLY
4	5050060	BAIL
5	5050065	SPINDLE ASSEMBLY

## NWJ HOISTING PLUG

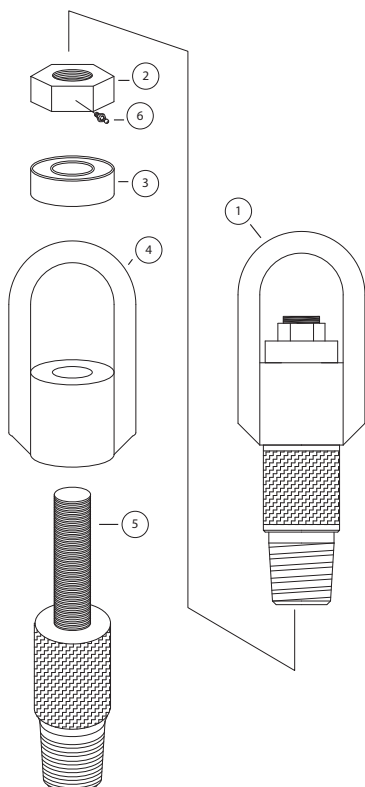

NWJ PIN HOISTING PLUG CAPACITY		
SIZE	ROTATING	STATIC
NWJ	21,400 lbs. / 9,707 kg	43,600 lbs. / 19,777 kg

NWJ PIN HOISTING PLUG		
ITEM	PART #	DESCRIPTION
1	5050001	HOISTING PLUG ASSEMBLY
2	5050070	NUT
3	5050075	BEARING ASSEMBLY
4	5050080	BAIL
5	5050085	SPINDLE ASSEMBLY
6	5050090	LOCKING SET SCREW

# HOISTING PLUGS

## NWL HOISTING PLUG

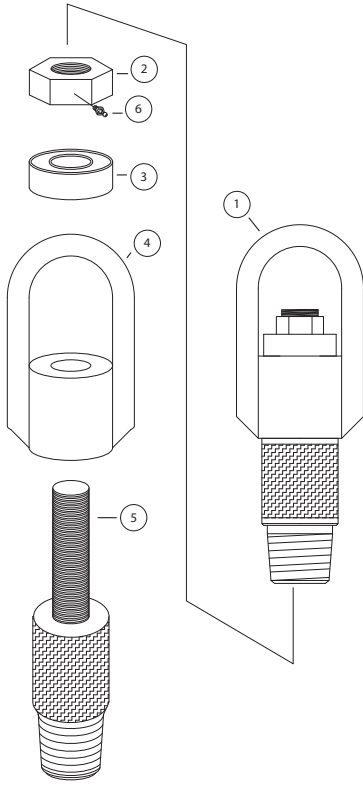

NWL PIN HOISTING PLUG CAPACITY		
SIZE	ROTATING	STATIC
NWL	21,400 lbs. / 9,707 kg	43,600 lbs. / 19,777 kg

NWL PIN HOISTING PLUG		
ITEM	PART #	DESCRIPTION
1	5050008	HOISTING PLUG ASSEMBLY
2	5050070	NUT
3	5050075	BEARING ASSEMBLY
4	5050080	BAIL
5	5050170	SPINDLE ASSEMBLY
6	5050090	LOCKING SET SCREW

## HWL HOISTING PLUG

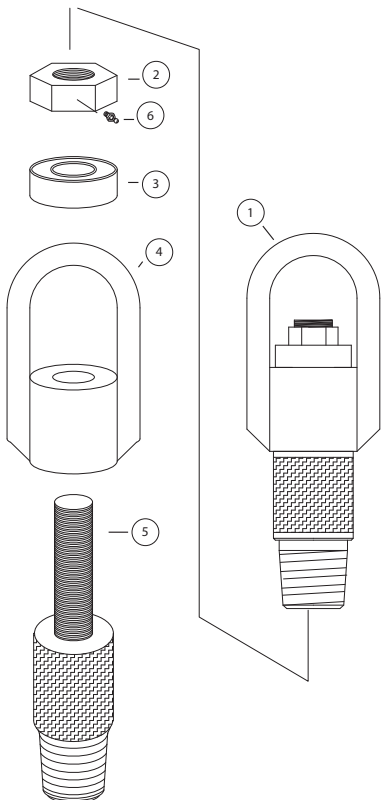

HWL PIN HOISTING PLUG CAPACITY		
SIZE	ROTATING	STATIC
HWL	21,400 lbs. / 9,707 kg	43,600 lbs. / 19,777 kg

HWL PIN HOISTING PLUG		
ITEM	PART #	DESCRIPTION
1	5050019	HOISTING PLUG ASSEMBLY
2	5050070	NUT
3	5050075	BEARING ASSEMBLY
4	5050080	BAIL
5	5050175	SPINDLE ASSEMBLY
6	5050090	LOCKING SET SCREW

# HOISTING PLUGS

## MURPHY FAST PLUG

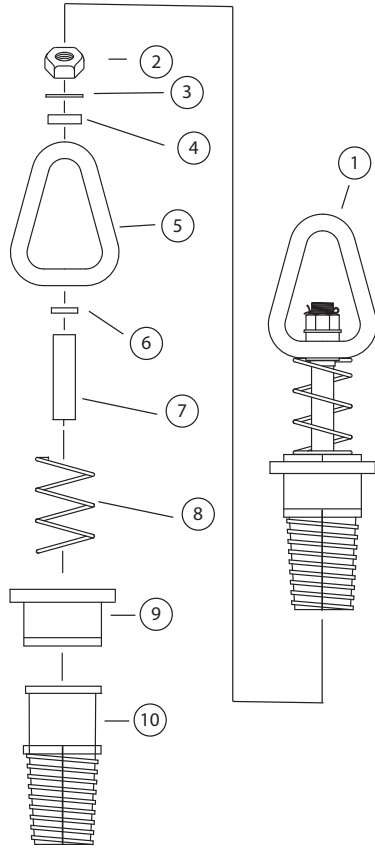

MURPHY FAST PLUG CAPACITY	
DESCRIPTION	LIFTING CAPACITY
2 3/8" BAIL	32,000 lbs.

MURPHY FAST PLUG		
ITEM	PART #	DESCRIPTION
1	5050003	NWJ COMPLETE ASSEMBLY*
	5050013	2 3/8" IF COMPLETE*
	5050044	2 3/8" MHJR COMPLETE ASSEMBLY*
2	5050125	CASTELLATED NUT
3	5050130	WASHER BEARING
4	5050135	THRUST BEARING
5	5050140	BAIL
6	5050145	SHOULDER WASHER
7	5050150	SHANK
8	5050155	SAFETY SPRING **
9	5050160	PLUG
10	5050165	SLEEVE

\* Additional sizes and thread profiles are available.

\*\*Replace bad or worn safety spring to ensure safe operation.

## HOISTING PLUG

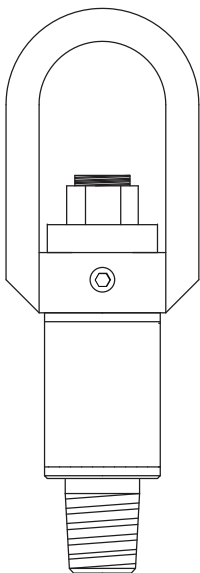

HOISTING PLUG CAPACITY	
DESCRIPTION	LIFTING CAPACITY
LD (LIGHT DUTY)	NON-RATED
HD (HEAVY DUTY)	20,000 - 40,000 lbs.

HOISTING PLUG	
PART #	DESCRIPTION
5050030	2 3/8" IF PIN LD SWIVEL
5050032	2 7/8" IF PIN LD SWIVEL
5050011	3 1/2" REG PIN LD SWIVEL

HOISTING PLUG	
PART #	DESCRIPTION
5050020	2 3/8" IF PIN HD SWIVEL 40K
5050009	3 1/2" REG PIN HD SWIVEL 40K
5050010	3 1/2" FH PIN HD SWIVEL 40K
5050023	3 1/2" API BOX SWIVEL 20K

Additional thread patterns are available.



## PIPE ELEVATORS

Hole Products offers standard (SD) and heavy duty (HD) pipe elevators in a multiple sizes to fit a variety of project requirements.

SD pipe elevators are commonly used for lifting threaded and coupled pipe. The pipe is elevated by lifting against the bottom side of the coupling.

HD pipe elevators are commonly used for casing installation, setting well screens, and pulling pump columns.

Additional sizes are available on request.

PIPE ELEVATORS (SD)		
PART #	PIPE SIZE	RATING
5000005	1"	6,000 lbs.
5000010	1 1/4"	6,000 lbs.
5000015	1 1/2"	6,000 lbs.
5000020	2"	6,000 lbs.



PIPE ELEVATORS (HD)		
PART #	PIPE SIZE	RATING
5000014	1"	36,000 lbs.
5000011	1 1/4"	42,000 lbs.
5000012	1 1/2"	52,000 lbs.
5000013	2"	38,000 lbs.



## PVC CASING ELEVATORS

PVC casing elevators are a safe and efficient way to install bell end PVC well casing. All elevators are manufactured from 1/4" steel and come equipped with high quality, zinc plated chains. PVC elevators are sold in pairs; one to hold the casing, and one to lift. Additional elevators for pipe sizes from 1/2" – 16" are available on request.

PVC CASING ELEVATORS		
PART #	PIPE SIZE	RATING
5000070	2"	2,000 lbs.
5000073	3"	2,000 lbs.
5000075	4"	2,000 lbs.
5000078	6"	2,000 lbs.



## CASING LIFTERS

Hole Products offers casing lifters and replacement parts to fit 6" and 8" casing. Additional sizes are available on request.

Casing lifters allow users to quickly elevate casing and simplify alignment during welding or coupling. The unique design makes pipe alignment easier during welding or threading applications.

CASING LIFTERS	
PART #	DESCRIPTION
5000025	6" COMPLETE
5000026	8" COMPLETE
5000035	6" OR 8" SET SCREW
5000027	6" OR 8" ARM W/ SET SCREW
5000030	6" BASE
5000110	8" BASE



## PIPE TONGS

Pipe tongs are designed to grip pipe for hoisting and permit an automatic release of the pipe when the lift line is slacked off. All pipe tongs come equipped with field replaceable grip pads that provide safe and positive engagement of the pipe. Additional tongs for pipe sizes up to 36" are available on request.

PIPE TONGS			
PART #	DESCRIPTION	PIPE USE	CAPACITY
5000107	3" TONGS	3.500" OD PIPE	2,000 lbs.
5000102	6" TONGS	5.875" OD PIPE	3,000 lbs.
5000101	7" TONGS	7.500" OD PIPE	3,000 lbs.
5000100	8" TONGS	8.625" OD PIPE	3,500 lbs.
5000098	10" TONGS	10.750" OD PIPE	4,000 lbs.



## AUGER HOISTING CAPS

Hoisting caps are used to pull more than one continuous flight auger section at a time using the rig's main hoist.

AUGER HOISTING CAPS		
PART #	HEX	
	IN	MM
5050036	1 1/8"	29
5050035	1 5/8"	41
5050037	2"	51



## LIFT RINGS

Hole Products' lift rings are available in a variety of rod sizes, open and closed styles, and standard or long shank models.

Lift rings are designed for removing drill rod from the hole. Using the rigs hoist, the ring is pulled upward, causing it to tilt and grab securely to the rod.



LIFT RINGS			
<b>OPEN</b>			
AW	BW	N	NW
5100005	5100004	5100006	5100011
<b>CLOSED</b>			
AW	BW	N	NW
5100000	5100003	5100001	5100010
<b>LONG SHANK LIFT RINGS</b>			
<b>OPEN</b>			
AW	BW	N	NW
5100020	----	----	----
<b>CLOSED</b>			
AW	BW	N	NW
5100015	----	----	----

## SELF-LOCKING SWIVEL HOOKS

The self-locking swivel hook allows for swiveling and easy positioning. When placed under a load, the latch closes automatically and will not open. Repair kits are available for all self-locking swivel hooks.

SELF LOCKING HOOKS				
Bronze Bushings (Swivel Eye Type)				
PART #	MODEL	CABLE SIZE	GRADE**	WORKING LOAD LIMIT* (LB) at 90°
5160001	BKL 5/6-10	7/32"	100	2,700
5160000	BKL 7/8-10	9/32"	100	4,300
5160005	BKL 10-10	3/8"	100	8,800
5160030	BKL 13 10	1/2"	100	15,000
5160010	BKL 16-10	5/8"	100	22,600

\*Design factor 4:1 Proof tested and certified.

\*\*Grade 100 hooks have recessed trigger.



SELF LOCKING LATCH REPAIR KIT			
Bronze Bushings (Swivel Eye Type)			
PART #	MODEL	CHAIN SIZE	GRADE
5160013	BKL 5/6-10	7/32"	100
5160014	BKL 7/8-10	9/32"	100
5160015	BKL 10-10	3/8"	100
5160020	BKL 13-10	1/2"	100
5160025	BKL 16-10	5/8"	100

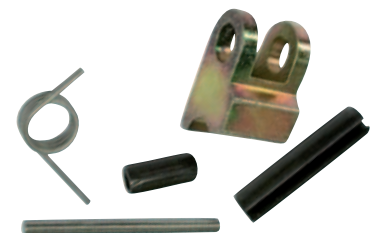

# KWIK KLAMPS™

Kwik Klamps™ are a time saving and safe tool designed for clamping and holding pipe. They are lightweight, easy to use, and provide excellent holding capability. The adjustable jaws allow for use with multiple pipe sizes and most have a safety pin to prevent accidental unclamping.

KWIK KLAMP 1		
ITEM	PART #	DESCRIPTION
1	4950005	COMPLETE CLAMP - 1" TO 2" PIPE SIZE
2	4950041	ADJUSTABLE SCREW W/ NYLON WASHER
3	4950012	JAW SET
4	4950017	SUPER JAW SET

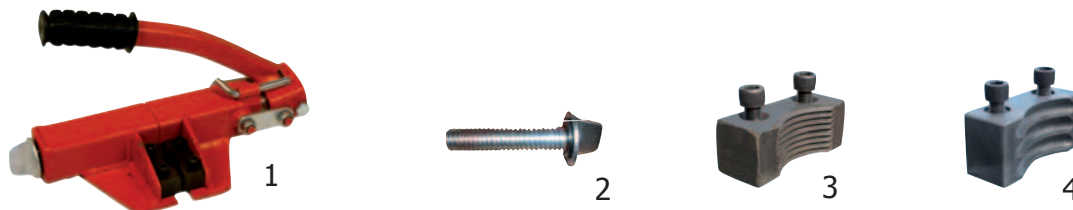

KWIK KLAMP 2		
ITEM	PART #	DESCRIPTION
1	4950010	COMPLETE CLAMP - 2 1/2" TO 4" PIPE SIZE
2	4950045	ADJUSTABLE SCREW W/ NYLON WASHER
3	4950011	CARBIDE TIP GRIPPER - 3/8" - 16" x 1/2"
4	4950019	JAW SET W/BOLTS (Specially designed for holding 2" and 2 1/2" pipe)*
5	4950050	SPACER

\*Kwik Klamp 2 can also hold 2" pipe with an additional jaw set and 4 1/2" pipe with a set of spacers. (See fig. 4 & 5)

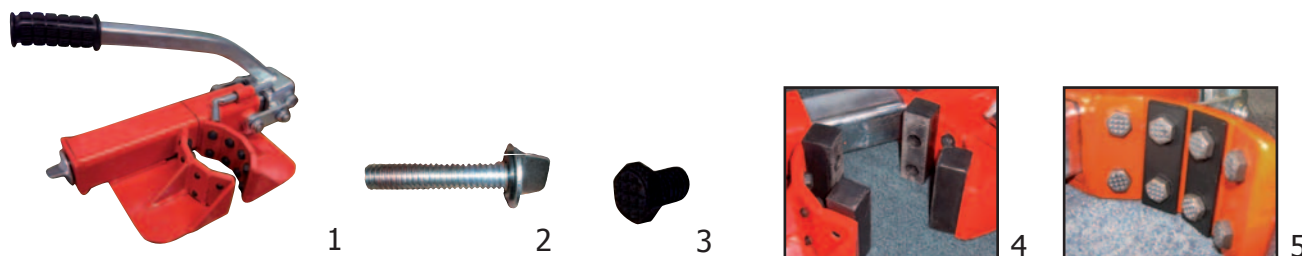

KWIK KLAMP 3		
ITEM	PART #	DESCRIPTION
1	4950006	COMPLETE CLAMP - 6" PVC PIPE ONLY*
2	4950070	ADJUSTABLE SCREW W/ NYLON WASHER
3	4950075	CARBIDE TIP GRIPPER - 3/8" - 16" x 1"
4	4950001	CONVERSION KIT FOR 5" PIPE (10 Jaw pads & 20 Carbide Tipped Gripper Bolts)

\*Kwik Klamp 3 can also hold 5" pipe with additional jaw set (conversion kit) (See fig. 4 & 5).



# STRAIGHT PIPE WRENCHES

Hole Products offers RIDGID® pipe wrenches and replacement parts in all standard sizes.

Additional wrenches are available. Please contact your Hole Products representative for details.



### Features

- Professional strength in lightweight aluminium.
- Offers the same durability and ease-of-use found in all RIDGID® heavy-duty wrenches.

ALUMINUM STRAIGHT PIPE WRENCHES			
PART #	NOMINAL SIZE	PIPE CAPACITY	WEIGHT (LB)
5150004	10"	1 1/2"	1
5150005	12"	2"	2 1/2
5150010	14"	2"	2 1/2
5150015	18"	2 1/2"	3 3/4
5150025	24"	3"	6
5150020	36"	5"	11
5150036	48"	6"	18 1/2



### Features

- Sturdy, cast-iron housing and I-beam handle with full floating forged hook jaw, featuring self-cleaning threads with replaceable hook and heel jaws.
- Heavy-duty pipe wrenches comply with federal specifications GGG-W65IE, Type II, Class A.

STEEL STRAIGHT PIPE WRENCHES			
PART #	NOMINAL SIZE	PIPE CAPACITY	WEIGHT (LB)
5150003	10"	1 1/2"	1 3/4
5150042	12"	2"	2 3/4
5150240	14"	2"	3 1/2
5150016	18"	2 1/2"	5 3/4
5150045	24"	3"	9 3/4
5150040	36"	5"	19
5150035	48"	6"	34 1/4
5150030	60"	8"	51 1/4

# PIPE WRENCH REPLACEMENT PARTS

Hole Products offers a full line of genuine RIDGID® replacement parts including nuts, pins, heel jaw and pin assemblies, coil and flat spring assemblies, and jaw hooks.

PIPE WRENCH REPLACEMENT PARTS					
NOMINAL SIZE	HEEL JAW AND PIN	JAW HOOK	JAW PIN	NUT	COIL AND FLAT SPRING ASSEMBLY
10"	5150062	5150088	5150063	5150119	5150270
12"	5150064	5150089	5150245	5150122	5150275
14"	5150064	5150090	5150250	5150121	5150280
18"	5150065	5150095	5150255	5150126	5150058
24"	5150070	5150100	5150260	5150120	5150285
36"	5150075	5150105	5150265	5150124	5150290
48"	5150080	5150110	5150082	5150125	5150076
60"	5150085	5150115	5150086	5150130	5150001

HEEL JAW AND PIN

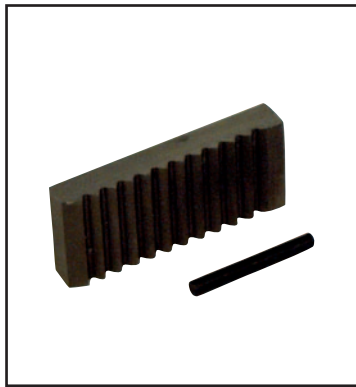

JAW HOOK



JAW PIN

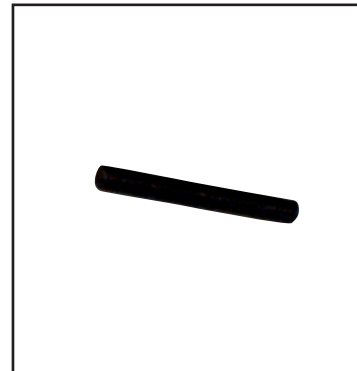

NUT



COIL AND FLAT SPRING ASSEMBLY



## CHAIN WRENCHES

Hole Products offers steel RIDGID® chain wrenches and replacement chains in all standard sizes.



CHAIN WRENCHES						
PART #	MODEL #	RATED PIPE CAP.	ACTUAL O.D. CAP	CHAIN LENGTH	WEIGHT (lb)	REPLACEMENT CHAIN PART #
5150043	C-12	2"	4"	15 3/4"	1 3/4	5150142
5150050	C-14	2"	5"	18 1/2"	2 3/4	5150143
5150034	C-18	2 1/2"	5"	20 1/4"	6	5150056
5150055	C-24	5"	5"	20 1/4"	8 1/4	5150056
5150060	C-36	4 1/2"	7 1/2"	29"	15 3/4	5150061

### Features

- A double fast jaw gives fast, ratchet-like action in either direction.
- The heavy-duty model has replaceable alloy steel jaws.
- The light-duty model has a one-piece forged alloy steel handle and jaw.
- Ideal for use in close quarters.

## PETOL TOOLS®

Hole Products is an authorized dealer of Petol Tools®. We offer a complete range of Petol wrenches and equipment for use in various areas of the drilling industry. Additional Petol tools are available on request.

Please contact your Hole Products representative for complete details.

PETOL CHAIN TONGS			
O.D.	GRIPPING WIDTH	HANDLE LENGTH	WEIGHT
1 1/2" - 6"	2.62"	30"	18 lbs.
2" - 10"	3.13"	44"	35 lbs.
PETOL DRILL PIPE TONGS			
1" - 6"	4.00"	8"	12 lbs.
2 1/8" - 5"	4.44"	12"	27 lbs.
2 1/8" - 5"	4.44"	21"	31 lbs.
3" - 8 1/4"	5.00"	8"	40 lbs.
3" - 8 1/4"	5.00"	12"	43 lbs.
3" - 8 1/4"	5.00"	21"	45 lbs.
4 1/4" - 10 3/4"	4.88"	10"	49 lbs.
4 1/4" - 10 3/4"	4.88"	36"	74 lbs.
4" - 14"	7.25"	9"	91 lbs.
4" - 14"	7.25"	18"	120 lbs.
4" - 14"	7.25"	23"	114 lbs.
4" - 14"	7.25"	28"	122 lbs.
4" - 14"	7.25"	36"	129 lbs.