

DRILL RODS & SUBS TABLE OF CONTENTS

DRILL ROD & SUB OVERVIEW.....2

API THREAD GUIDE.....3

DRILL RODS 4-10

- Rotary Drill Rod Ordering Guide.....4
- Rotary Drill Rod.....5
- Conventional Drill Rod.....6-7
- Sonic Drill Rod.....8
- Wireline Drill Rod.....9
- Reverse Circulation Drill Rod.....10

ROD WIPERS 12-13

COMPOUNDS & GREASES 14

STABILIZERS.....15

FLOAT VALVES.....16

SUBS 17-28

- DCDMA Adapter Subs 18-23
- API Adapter Subs 24-25
- Sonic Subs 26-27
- Auger Adapters 28
- Reverse Circulation Subs 28



DRILL RODS & SUBS



Hole Products offers a complete line of quality rotary, conventional (W, WJ, & N), sonic, wireline and reverse circulation drill rods, and a vast range of subs. In addition, we offer a variety of components and accessories including stabilizers, float valves, rod wipers, rod grease, and more.

All products are quality manufactured using premium materials and advanced manufacturing techniques reliability, ensuring superior performance, and longevity in even the most demanding drilling conditions.

Drill rods and subs listed in the catalog are representative of the drilling industry's most common sizes and styles. If you do not see the product you are looking for, give us a call. Custom rods and subs are available on request.

Please contact your Hole Products representative for additional details.

Products listed in the catalog are representative of the most common industry sizes and styles. Please contact your Hole Products representative for additional product offerings.

API THREAD GUIDE

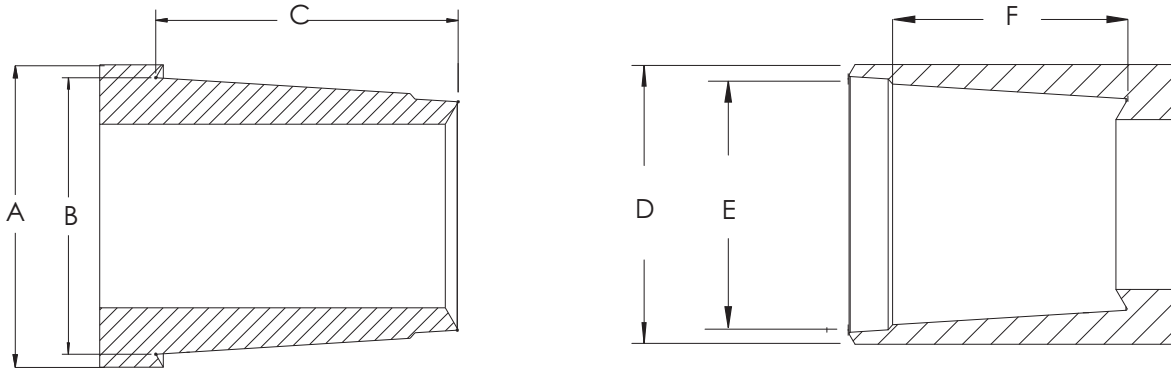

THREAD	O.D. (A)	MAJOR THREAD DIAMETER PIN (B)	LENGTH OF PIN (C)	O.D. (D)	MAJOR THREAD DIAMETER BOX (E)	LENGTH OF BOX (F)
2 3/8" API Reg.	3 3/8"	2 1/2"	2 7/8"	3 3/8"	2 11/16"	3 1/8"
2 7/8" API Reg.	3 7/8"	2 7/8"	3 3/8"	3 7/8"	3 1/16"	3 5/8"
3 1/2" API Reg.	4 3/8"	3 3/8"	3 5/8"	4 3/8"	3 9/16"	3 7/8"
4 1/2" API Reg.	5 3/4"	4 1/2"	4 1/8"	5 3/4"	4 3/8"	4 11/26"
2 3/8" API IF	3 5/8"	2 3/4"	2 7/8"	3 5/8"	2 15/16"	3 1/8"
2 7/8" API IF	4 1/4"	3 1/4"	3 3/8"	4 1/4"	3 1/2"	3 5/8"
3 1/2" API IF	5"	3 7/8"	3 7/8"	5"	4 1/8"	4 1/8"
4 1/2" API IF	6 3/4"	5 1/8"	4 3/8"	6 3/4"	5 5/16"	4 5/8"
2 3/8" MHJR	2 3/4"	2 21/64"	2 1/4"	4"	2"	1 1/2"

ROTARY DRILL ROD ORDERING GUIDE

Hole Products offers a complete line of premium rotary drill rods for use on rigs from a variety of rig manufacturers including Atlas Copco, CP/Reichdrill, Driltech, Foremost, Ingersoll-Rand, Schramm, and more. All rotary rods are manufactured using high quality alloy materials ensuring excellent performance and durability.

Rotary rods are offered with a variety of custom options including multiple thread profiles, lengths, O.D.s, wall thicknesses, wrench flat options, and more.

Please contact your Hole Products representative for assistance ordering the rotary drill rods best suited for your specific drilling application.

ROTARY DRILL ROD ORDERING GUIDE		
O.D.:		
Wall Thickness:		
Length:		
Threads:		
Rod Style:		
Flats:	Box End	Pin End
A: (Long)		
B: (Up)		
C:		
D: (Tool Joint I.D.)		
Other Info:		

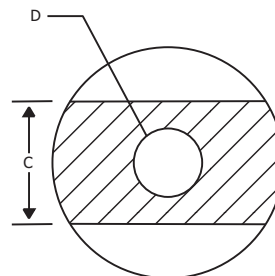
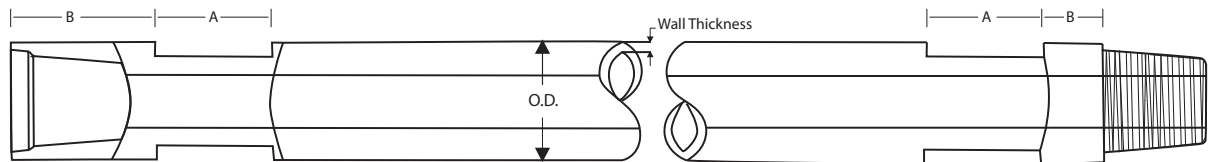

Cross Section of Flats

ROTARY DRILL ROD

Hole Products offers a wide range of rotary drill rods. Rotary rods are available in any size, length, and wall thickness, and with all thread connections and any custom flat configurations.

Due to the vast number of rotary drill rod options, we have listed only a sample of our standard offering in the table below.

Please contact your Hole Products representative for additional details.

ROTARY DRILL ROD					
PART #	O.D.	WALL THICKNESS	LENGTH	THREAD	FLATS
3200091	2 3/8"	.254"	20'	2 3/8" IF	N/A
3200069	2 7/8"	.308"	5'	2 3/8" MAYHEW JR.	N/A
3201007	2 7/8"	.362"	5'	2 3/8" MAYHEW JR.	N/A
3200100	2 7/8"	.308"	10'	2 3/8" MAYHEW JR.	N/A
3201008	2 7/8"	.362"	10'	2 3/8" MAYHEW JR.	N/A
3200032	3 1/2"	.250"	20'	2 3/8" IF	FLATS ON BOX END
3200026	3 1/2"	.368"	20'	2 3/8" IF	SCHRAMM BOTTLENECK
3200029	3 1/2"	.368"	20'	2 3/8" IF	INGERSOLL-RAND CYCLONE
3201019	4 1/2"	.337"	5'	3 1/2" API	CP
3200105	4 1/2"	.337"	10'	3 1/2" API	CP
3200071	4 1/2"	.337"	20'	2 7/8" IF	DRILTECH
3200070	4 1/2"	.337"	20'	2 7/8" IF	INGERSOLL-RAND CYCLONE
3200009	4 1/2"	.337"	20'	2 7/8" IF	SCHRAMM BOTTLENECK
3200010	4 1/2"	.337"	20'	3 1/2" API	SCHRAMM BOTTLENECK
3200110	4 1/2"	.337"	20'	3 1/2" API	STANDARD SCHRAMM



CONVENTIONAL DRILL RODS

Hole Products conventional drill rods are manufactured using high quality alloy tubing ensuring excellent performance and durability in even the most demanding drilling conditions. All rods are compatible with other rods manufactured to DCDMA standards, available in 1', 2', 5', 10', and 20' lengths, and offered with or without wrench flats.

AW, BW, NW, N3, and N4 rods come standard with pin x pin couplings. All couplings are made of 4140 alloy steel and heat treated.

Additional conventional drill rods including custom and metric lengths, rods with break out flats, and lightweight



CONVENTIONAL DRILL ROD SPECIFICATIONS							
SIZE	O.D.		MID BODY I.D.		THREADS PER INCH	WEIGHT	
	IN	MM	IN	MM		LBS/10 FT	KG/3M
AW	1.750"	44.50	1.250	31.80	3.0	44.00	19.60
BW	2.125"	54.00	1.750"	44.50	3.0	40.00	18.20
NW	2.625"	66.70	2.250"	57.10	3.0	51.00	23.30
AWJ	1.750"	44.50	1.374"	34.90	5.0	33.00	14.70
BWJ	2.130"	54.50	1.750"	44.50	5.0	40.00	18.20
NWJ	2.625"	66.70	2.250"	57.10	4.0	55.00	24.60
N3	2.380"	60.45	1.130"	28.70	3.0	80.10	36.33
N4	2.130"	54.10	1.000"	25.40	4.0	80.10	36.33



W DRILL ROD



WJ DRILL ROD



N DRILL ROD

CONVENTIONAL DRILL RODS

WJ THREADED ROD		
SIZE	PART #	LENGTH
AWJ	3050035	1'
	3050040	2'
	3050042	3'
	3050000	5'
	3050005	10'
BWJ	3050115	1'
	3050120	2'
	3050125	3'
	3050130	5'
	3050019	10'
NWJ	3050021	1'
	3050030	2'
	3050022	3'
	3050020	5'
	3050025	10'



W THREADED ROD		
SIZE	PART #	LENGTH
AW*	3050011	1'
	3050009	2'
	3050135	3'
	3050010	5'
	3050015	10'
BW*	3050140	1'
	3050145	2'
	3050150	3'
	3050017	5'
	3050155	10'
NW*	3050050	1'
	3050045	2'
	3050046	3'
	2150020	5'
	2150025	10'

*AW, BW, and NW come standard with pin x pin coupling.

N THREADED ROD		
SIZE	PART #	LENGTH
N3*	3050160	1'
	2150024	2'
	3050165	3'
	2150021	5'
	2150023	10'
N4*	3050170	1'
	3050175	2'
	3050180	3'
	3050003	5'
	3050185	10'

*N3 and N4 come standard with pin x pin coupling.

COUPLINGS

PIN X PIN COUPLINGS		
SIZE	PART #	WEIGHT (LBS.)
AW	3301095	2
BW	3301395	3.65
NW	3301096	5.25
N3	3301400	4
N4	3301405	4

SONIC DRILL RODS

Hole Products' sonic rods are specifically designed and manufactured to withstand the rigorous demands unique to sonic drilling. Rods are heat treated, inertia welded, and field tested under a variety of conditions, ensuring performance and durability in the most demanding applications.

In addition, Hole Products' sonic rods are internally upset. Internally upsetting rods lowers their weight while maintaining the outside diameter and the overall strength of the rods. A lighter rod means greater depth capabilities and less wear and tear on equipment and personnel.



HD DRILL ROD				
PART #	O.D.	I.D.*	LENGTH	THREAD
6360093	3 1/2"	2 1/4"	1'	HP90
6360063	3 1/2"	2 1/4"	2'	HP90
6360069	3 1/2"	2 1/4"	5'	HP90
6360096	3 1/2"	2 1/4"	10'	HP90
6360211	3 1/2"	2 1/4"	20'	HP90
6360212	3 1/2"	1 3/4"	1'	2 3/8" IF
6360213	3 1/2"	1 3/4"	2'	2 3/8" IF
6360070	3 1/2"	1 3/4"	5'	2 3/8" IF
6360040	3 1/2"	1 3/4"	10'	2 3/8" IF
6360214	3 1/2"	1 3/4"	20'	2 3/8" IF
6360215	4 1/2"	3 1/4"	1'	HP90
6360216	4 1/2"	3 1/4"	2'	HP90
6360217	4 1/2"	3 1/4"	5'	HP90
6360218	4 1/2"	3 1/4"	10'	HP90
6360219	4 1/2"	3 1/4"	20'	HP90
6360220	4 1/2"	2 1/8"	1'	2 7/8" IF
6360221	4 1/2"	2 1/8"	2'	2 7/8" IF
6360222	4 1/2"	2 1/8"	5'	2 7/8" IF
6360223	4 1/2"	2 1/8"	10'	2 7/8" IF
6360224	4 1/2"	2 1/8"	20'	2 7/8" IF
6360225	4 1/2"	3"	1'	ROUSSY
6360226	4 1/2"	3"	2'	ROUSSY
6360227	4 1/2"	3"	5'	ROUSSY
6360228	4 1/2"	3"	10'	ROUSSY
6360229	4 1/2"	3"	20'	ROUSSY

*I.D. is measured at the tool joint.

SD DRILL ROD				
PART #	O.D.	I.D.*	LENGTH	THREAD
6360230	3 1/2"	2 1/4"	1'	HP90
6360231	3 1/2"	2 1/4"	2'	HP90
6360232	3 1/2"	2 1/4"	5'	HP90
6360233	3 1/2"	2 1/4"	10'	HP90
6360234	3 1/2"	2 1/4"	20'	HP90
6360235	3 1/2"	1 3/4"	1'	2 3/8" IF
6360236	3 1/2"	1 3/4"	2'	2 3/8" IF
6360238	3 1/2"	1 3/4"	5'	2 3/8" IF
6360239	3 1/2"	1 3/4"	10'	2 3/8" IF
6360240	3 1/2"	1 3/4"	20'	2 3/8" IF
6360241	4 1/2"	3 1/4"	1'	HP90
6360242	4 1/2"	3 1/4"	2'	HP90
6360243	4 1/2"	3 1/4"	5'	HP90
6360244	4 1/2"	3 1/4"	10'	HP90
6360245	4 1/2"	3 1/4"	20'	HP90
6360246	4 1/2"	2 1/8"	1'	2 7/8" IF
6360247	4 1/2"	2 1/8"	2'	2 7/8" IF
6360248	4 1/2"	2 1/8"	5'	2 7/8" IF
6360249	4 1/2"	2 1/8"	10'	2 7/8" IF
6360250	4 1/2"	2 1/8"	20'	2 7/8" IF
6360251	4 1/2"	3"	1'	ROUSSY
6360252	4 1/2"	3"	2'	ROUSSY
6360253	4 1/2"	3"	5'	ROUSSY
6360254	4 1/2"	3"	10'	ROUSSY
6360255	4 1/2"	3"	20'	ROUSSY

*I.D. is measured at the tool joint.

WIRELINE DRILL RODS

Hole Products wireline (WL) drill rods are designed and manufactured to deliver excellent results and withstand the many different stresses placed on the drill string in coring operations.

All rods are compatible with other DCDMA standard rods and available in all standard industry sizes.



WIRELINE DRILL ROD SPECIFICATIONS							
SIZE	O.D.		I.D.		THREADS PER INCH	WEIGHT	
	IN	MM	IN	MM		LB/10 FT	KG/3M
BWL	2.188"	55.6	1.813"	46.0	3.0	42	18
NWL	2.750"	69.9	2.375"	60.3	3.0	52	23
HWL	3.500"	88.9	3.063"	77.8	3.0	77	34
HWT	4.500"	114.3	4.000"	101.6	2.5	117	52

WIRELINE DRILL ROD (Imperial Sizes)		
SIZE	PART #	LENGTH
BWL	2150051	1'
	2150052	2'
	2150055	5'
	2150050	10'
NWL	2150002	1'
	2150001	2'
	2150000	5'
	2150005	10'
HWL	2150008	1'
	2150009	2'
	2150010	5'
	2150015	10'
HWT*	2100008	1'
	2100007	2'
	2100011	5'
	2100034	10'

*HWT made from 4130 grade material.

*HWT casing is the recommended drill rod for PWL coring systems.

WIRELINE DRILL ROD (Metric Sizes)		
SIZE	PART #	LENGTH
BWL	2150060	1.5 M
	2150065	3 M
NWL	2150070	1.5 M
	2150016	3 M
HWL	2150018	1.5 M
	2150017	3 M
HWT *	2100145	1.5 M
	2100150	3 M

*HWT made from 4130 grade material.

*HWT casing is the recommended drill rod for PWL coring systems.

REVERSE CIRCULATION DRILL RODS

Hole Products offers a complete line of premium quality reverse circulation, dual wall drill rods, in a wide range of sizes, and with a number of thread connections. All RC rods are manufactured using the most advanced technologies and specifically engineered to provide high strength, excellent wear resistance and long life.

Reverse Circulation, dual wall drill rods are manufactured with an outer drill rod and an inner tube located inside the rod. When the drill rods are threaded together, the inner tubes seal together to provide a continuous route for cuttings to travel from the bit face to the surface for collection.

Please contact your Hole Products representative for additional details and ordering assistance.

REVERSE CIRCULATION DRILL ROD SPECIFICATIONS							
Thread Type	Remet	Remet	Remet	Metzke	Metzke	Matrix	Matrix
Rod O.D.	3 1/2"	4"	4 1/2"	4"	4 1/2"	4"	4 1/2"
Outer tube O.D.	88.9mm	101.7mm	114.3mm	101.7mm	114.3mm	101.7mm	114.3mm
Outer tube I.D.	81.8mm	94.6mm	107.2mm	94.6mm	107.2mm	94.6mm	107.2mm
Outer tube WT	5.3mm	7.1mm	7.1mm	7.1mm	7.1mm	7.1mm	7.1mm
Inner tube O.D.	38.1mm	50.8mm	63.5mm	50.8mm	63.5mm	50.8mm	63.5mm
Inner tube I.D.	32.6mm	45.3mm	58mm	45.3mm	58mm	45.3mm	58mm
Inner tube WT	5.5mm	5.5mm	5.5mm	5.5mm	5.5mm	5.5mm	5.5mm
Spanner Flat	90mm	90mm	90mm	90mm	90mm	90mm	90mm
Weight 3.0 m	75 kg.	75 kg.	95 kg.	75 kg.	95 kg.	75 kg.	95 kg.
Weight 6.0 m	120 kg.	150 kg.	168 kg.	150 kg.	168 kg.	150 kg.	168 kg.



ROD WIPERS

Hole Products provides high quality rod wipers to remove soil, mud, and water from drill rods.

Rods are drawn through the wipers allowing them to act as a squeegee while removing tooling from the hole.

Additional sizes and styles including rubber crown profile and dual split are available on request.

Please refer to the guidelines below when ordering wipers.



ROD WIPER ORDERING GUIDELINES

I.D.: *	
O.D.:	
Rod Size:	
Steel or No Steel:	

*Recommended 1/4" smaller than rod O.D.

ROD WIPER WITH STEEL* - FLAT PROFILE

PART #	O.D.	I.D.	THICKNESS	RECOMMENDED ROD O.D.
3151041	9"	1 1/2"	3/4"	1 3/4"
3150045	9"	2"	3/4"	2 1/4"
3150012	9"	2 1/8"	3/4"	2 1/2"
3151042	9"	2 1/4"	3/4"	2 1/2"
3150165	8"	2 1/2"	1"	2 3/4"
3151024	9"	2 1/2"	3/4"	2 3/4"
3150170	8"	3 1/4"	1"	3 1/2"
3150010	9"	3 1/4"	3/4"	3 1/2"
3150020	12"	3 1/4"	3/4"	3 1/2"
3150175	8"	3 1/2"	1"	3 3/4"
3150180	8"	3 3/4"	1"	4"
3150185	5"	4 1/4"	3/4"	4 1/2"
3150190	6"	4 1/4"	3/4"	4 1/2"
3150195	8"	4 1/4"	1"	4 1/2"
3150015	9"	4 1/4"	3/4"	4 1/2"
3151001	11"	4 1/4"	3/4"	4 1/2"
3150025	12"	4 1/4"	3/4"	4 1/2"
3151039	14"	4 1/4"	3/4"	4 1/2"
3150028	19"	4 1/4"	3/4"	4 1/2"
3150200	8"	4 1/2"	1"	4 3/4"

*More rigid less flexible wiper.

ROD WIPERS

ROD WIPER NO STEEL* - FLAT PROFILE				
PART #	O.D.	I.D.	THICKNESS	RECOMMENDED ROD O.D.
3150035	9"	1 1/2"	3/4"	1 3/4"
3150040	9"	2"	3/4"	2 1/4"
3150133	9"	2 1/4"	3/4"	2 1/2"
3151008	8"	2 1/2"	1"	2 3/4"
3151025	9"	2 1/2"	3/4"	2 3/4"
3151012	8"	3 1/4"	1"	3 1/2"
3150011	9"	3 1/4"	3/4"	3 1/2"
3150021	12"	3 1/4"	3/4"	3 1/2"
3151013	8"	3 3/4"	1"	4"
3151009	8"	3 1/2"	1"	3 3/4"
3151031	5"	4 1/4"	3/4"	4 1/2"
3151030	6"	4 1/4"	3/4"	4 1/2"
3151011	8"	4 1/4"	1"	4 1/2"
3150016	9"	4 1/4"	3/4"	4 1/2"
3150135	11"	4 1/4"	3/4"	4 1/2"
3150140	14"	4 1/4"	3/4"	4 1/2"
3150145	19"	4 1/4"	3/4"	4 1/2"
3151010	8"	4 1/2"	1"	4 3/4"
3150031	12"	5"	3/4"	5 1/2"
3150041	12"	7"	3/4"	7 1/4"
3150029	12"	8 5/8"	3/4"	9"

*A more flexible wiper.



COMPOUNDS & GREASES

Hole Products offers a variety of high quality thread compounds, locking compounds, and rod grease, from the industry's leading manufacturers. Products are available to meet any criteria from environmental concerns, high or low temperatures, extreme exposure to the elements, high pressures and more.



Please contact your Hole Products representative for additional information and assistance selecting the product(s) best suited for your drilling application.

THREAD COMPOUNDS			
PART #	UNIT SIZE	PRODUCT	PRODUCT DESCRIPTION
3100040	1 GAL.	BULLSEYE®	BULLSEYE® provides protection against galling, seizing, and thread damage while maintaining well integrity.
3100005	1 GAL.	COPR PLUS	COPR PLUS is an environmentally friendly non-lead, non-zinc thread compound, which provides protection against galling and seizing.
3100010	2 GAL.		
3100011	5 GAL.		
3100013	5 GAL.	JET-LUBE® 21®	JET-LUBE® 21® is formulated to reduce excessive circumferential make-up of tool joints and protect against galling and high stress.
3100050	1 GAL.	KOPR-KOTE®	KOPR-KOTE® is formulated to help reduce downhole joint make-up. It has a very high static friction factor that helps reduce downhole joint make-up when excessive drilling torques are encountered.
3100055	2 GAL.		
3100070	1 GAL.	KOPR-KOTE® ARCTIC	KOPR-KOTE® ARCTIC is designed for extreme cold weather environments where fluid film strength is important and grease consistency remains the same.
3100071	2 GAL.		
3100059	2.5 GAL.	KOV'R-KOTE®	KOV'R-KOTE® is a metal-free formula and is ideal for mineral exploration tooling string. It has additives for rust corrosion and oxidation protection.
3100030	1 GAL.	ORANGE AID	ORANGE AID is a hydrocarbon free tool joint compound, which contains no metals, lead / copper and protects and lubricates drill pipe threads.
3100060	1 GAL.	WELL-GUARD®	WELL-GUARD® is designed for critical monitor well and other environmentally sensitive drilling applications requiring the use of a petroleum hydrocarbon-free product.
LOCKING COMPOUND			
3100085	8 OZ	BAKERLOK THREAD COMPOUND KIT	BAKERLOK is a thread locking compound, commonly used for casing, tubing, and drilling joints to reduce accidental detaching of string components during drilling.
ROD GREASE			
3100036	5 GAL.	IDP-214	IDP-214 rod grease is a high quality, easily applied formulation designed to help dampen high frequency vibration created in continuous wireline coring operations.

DOPE BRUSHES

DOPE BRUSHES			
PART #	DESCRIPTION	TRIM LENGTH	OVERALL LENGTH
6100020	TAPERED W/ GUARD	2 1/2"	16"
3100025	BEVELED W/ GUARD	2 1/2"	16"





STABILIZERS

Hole Products’ stabilizers are designed to reduce unintentional sidetracking and vibrations, thus keeping the drill string centered in the borehole. All stabilizers are manufactured from high strength steel and feature heat treated tool joints and hard faced wear surfaces.

Each style can be customized with a variety of options including O.D., length (body and neck), thread connection, flats, and more.

Additional stabilizers including replaceable sleeve and integral blade stabilizers are available on request.

Please refer to the guide below when ordering stabilizers.

STABILIZER STYLES	
	SMOOTH BODY: standard stabilizer with no blades.
	STRAIGHT BLADE: feature welded straight blades on the body.
	SPIRAL BLADE: spiral blades provide constant wall contact to assist in cutting removal.
	STRAIGHT-SPIRAL BLADE: designed to provide the benefits of the spiral blade stabilizer at a reduced cost.
	FLOW THROUGH: allows cuttings to pass between the inner and outer barrel.

STABILIZER ORDERING REFERENCE GUIDE										
STYLE:	SMOOTH		FLOW - THROUGH		STRAIGHT BLADE		SPIRAL BLADE		STRAIGHT-SPIRAL RIBBED	
	SPECIFY # OF BLADES	---	SPECIFY # OF BLADES	---	SPECIFY # OF BLADES	---	SPECIFY # OF BLADES	---	SPECIFY # OF BLADES	---
BODY O.D.:										
BODY LENGTH:										
NECK LENGTH:										
TOP CONNECTION:										
BOTTOM CONNECTION:										
FLATS:										
OTHER INFO:										

FLOAT VALVES

Float valves provide added blowout protection at the bottom of the drill string to reduce flow-back when making connections. They also keep cuttings out of the drill string which reduces bit plugging.

Hole Products offers a complete line of Model "F" plunger type and Model "G" flapper style float valves and repair kits to accommodate a wide range of drilling conditions.

Model "F" float valves offer positive and instant shut-off, economy, and durability.

Model "G" float valves are designed for highly abrasive drilling fluids. The cast flapper is designed to open quickly, providing unrestricted full flow through the valve.

Please contact your Hole Products representative for additional information and assistance selecting the float valve best suited for your drilling needs.

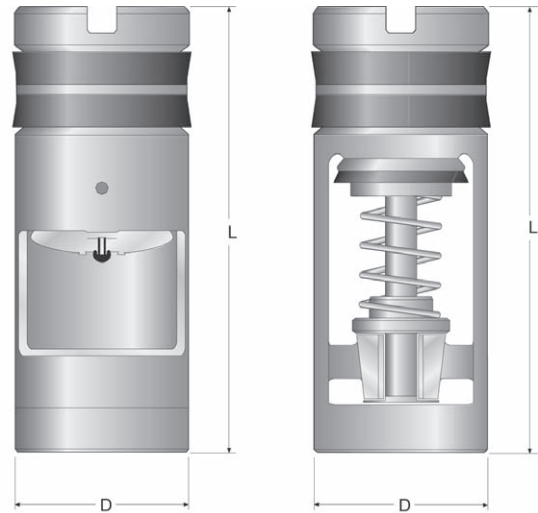

FLOAT VALVE DIMENSIONAL DATA					
VALVE SIZE	DIAMETER OF VALVE	DIAMETER OF RECESS FOR VALVE	LENGTH OF VALVE	I.D. OF VALVE	
				MODEL F	MODEL G
	(D) - IN	IN	(L) - IN	IN	IN
1R	1 21/32"	1 11/16"	5 7/8"	1"	N/A
1F-2R	1 29/32"	1 15/16"	6 1/4"	1 1/4"	1"
2F-3R	2 13/32"	2 7/16"	6 1/2"	1 9/16"	1 1/4"
3F	2 13/16"	2 27/32"	10"	1 7/8"	1 5/8"
3 1/2 IF	3 1/8"	3 5/32"	10"	1 7/8"	1 5/8"
4R	3 15/32"	3 1/2"	8 5/16"	2 15/16"	1 31/32"
4F	3 21/32"	3 11/16"	12"	2 1/2"	2 3/16"
5R	3 7/8"	3 29/32"	9 3/4"	2 3/4"	2 1/4"
5F-6R	4 25/32"	4 13/16"	11 3/4"	3 1/4"	2 7/8"
6F	5 11/16"	5 23/32"	14 5/8"	4 1/8"	N/A

SUBS

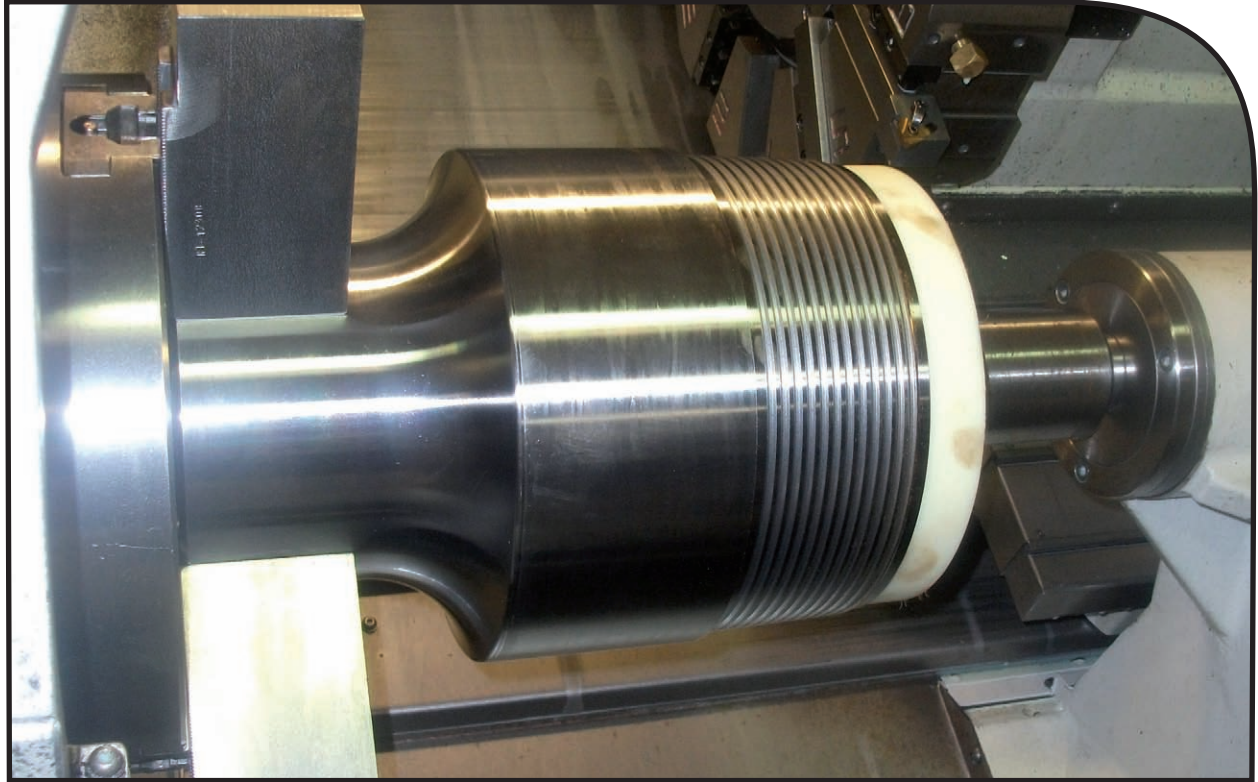

SUBS

It isn't easy matching multiple tooling sizes and styles and maintaining inventory of accessories that will work on multiple jobs.

To make sure you get the perfect fit every time, Hole Products offers a complete line of quality adapter subs.

Looking for a specialty or hard to find sub? Hole Products can custom manufacture any sub, in any size, with any connection, and with a variety of custom options including: o-ring seals, check valves, breakout flats, and much more.

Adapter subs shown are representative of the most common industry sizes and styles.

Please contact your Hole Products representative for additional product availability or assistance ordering custom subs.

DCDMA ADAPTER SUBS

AW ROD BOX X PIN		
PART #	ROD BOX	PIN
3300058	AW	BWL ROD
3300300	AW	BW CASING
3301070	AW	NWL ROD
3301192	AW	NXB 3 TPI
3301080	AW	NW CASING
3301031	AW	HWL ROD
3301068	AW	HW CASING

AWJ ROD BOX X PIN		
PART #	ROD BOX	PIN
3300305	AWJ	BWL ROD
3301172	AWJ	BW CASING
3301065	AWJ	NWL ROD
3300311	AWJ	NXB 3 TPI
3301085	AWJ	NW CASING
3301170	AWJ	HWL ROD
3301097	AWJ	HW CASING
3301094	AWJ	HWT CASING
3301102	AWJ	PW CASING

BW ROD BOX X PIN		
PART #	ROD BOX	PIN
3301104	BW	NWL ROD
3301106	BW	NW CASING



DCDMA ADAPTER SUBS

NWJ ROD BOX X PIN		
PART #	ROD BOX	PIN
3301026	NWJ	AW
3301025	NWJ	AWJ
3301213	NWJ	BWJ
3300320	NWJ	BWL ROD
3300325	NWJ	BW CASING
3301129	NWJ	N3 ROD
3301124	NWJ	N4 ROD
3301128	NWJ	NW ROD
3301199	NWJ	NWJ
3301116	NWJ	NWL ROD
3301115	NWJ	NW CASING
3301204	NWJ	NXB 3 TPI
3301115	NWJ	NW CASING
3301027	NWJ	HWL ROD
3300330	NWJ	HWL ROD W/ O-RING
3301117	NWJ	HW CASING
3301028	NWJ	HWT CASING
3300335	NWJ	HWT W/ O-RING
3300150	NWJ	PW CASING
3301119	NWJ	PWL ROD
3300153	NWJ	CPWL ROD
3300150	NWJ	PW CASING
3300151	NWJ	PWT ROD
3301118	NWJ	SW CASING
3301220	NWJ	ZW CASING
3301200	NWJ	1 1/4" 7 TPI
3301009	NWJ	2 3/8" IF
3301018	NWJ	2 3/8" API
3301023	NWJ	2 7/8" API REG
3301024	NWJ	MHJR PIN
3305060	NWJ	1 1/4" API

NW ROD BOX X PIN		
PART #	ROD BOX	PIN
3300345	NW	BWL ROD
3300350	NW	BW CASING
3301074	NW	NWL ROD
3300087	NW	NWL ROD W/ O-RING
3301079	NW	NW CASING
3301081	NW	HWL ROD
3300088	NW	HWL ROD W/ O-RING
3301114	NW	HW CASING
3301207	NW	HWT CASING
3300089	NW	HWT W/ O-RING
3301082	NW	PW CASING
3302098	NW	PWT ROD



BWL ROD BOX X PIN		
PART #	ROD BOX	PIN
3302053	BWL	NWL ROD
3302180	BWL	BW CASING

DCDMA ADAPTER SUBS

NWL ROD BOX X PIN		
PART #	ROD BOX	PIN
3301143	NWL	EW CASING
3300008	NWL	AW ROD
3301187	NWL	AW CASING
3300118	NWL	BWL ROD
3300355	NWL	BW CASING
3300017	NWL	NW ROD
3300108	NWL	NWJ ROD
3300104	NWL	NWL ROD
3301195	NWL	NXB 3 TPI ROD
3301217	NWL	NXE 4 TPI ROD
3300016	NWL	NW CASING
3300006	NWL	HWL ROD
3300113	NWL	HW CASING
3300038	NWL	HWT CASING

NXB 3 TPI BOX X PIN		
PART #	BOX	PIN
3300031	NXB 3 TPI	NWJ ROD
3302003	NXB 3 TPI	NWL ROD

NW CASING BOX X PIN		
PART #	CASING BOX	PIN
3301088	NW	HWL ROD



DCDMA ADAPTER SUBS

HWL ROD BOX X PIN		
PART #	ROD BOX	PIN
3302004	HWL	AW ROD
3300009	HWL	NWJ ROD
3300360	HWL	NWL ROD
3300073	HWL	NW CASING
3300365	HWL	HWL ROD
3300007	HWL	HW CASING
3300011	HWL	HWT CASING

HW CASING BOX X PIN		
PART #	CASING BOX	PIN
3302134	HW	HWL ROD
3300109	HW	HWT CASING / ROD
3301133	HW	CPWL ROD

HWT ROD BOX X PIN		
PART #	ROD BOX	PIN
3300255	HWT	HWL ROD
3301133	HWT	CPWL ROD
3300014	HWT	HW CASING
3300370	HWT	HWT
3300261	HWT	PW CASING
3302095	HWT	PWT ROD
3301071	HWT	SWT ROD

CPWL ROD BOX X PIN		
PART #	ROD BOX	PIN
3300152	CPWL	HWT CASING / ROD

PWT CASING BOX X PIN		
PART #	CASING BOX	PIN
3302097	PWT	PW CASING



DCDMA ADAPTER SUBS

PIN X PIN		
PART #	PIN	PIN
3301130	AW ROD	AWJ ROD
3302125	AW ROD	BWL ROD
3302140	AW ROD	BW CASING
3301092	AW ROD	NWJ ROD
3302116	AW ROD	NWL ROD
3301169	AW ROD	NXB 3 TPI ROD
3302126	AW ROD	NW CASING
3300262	AW ROD	HWL ROD
3301123	AW ROD	HWT ROD
3301057	AWJ ROD	AWJ ROD
3301103	AWJ ROD	NW ROD
3301227	BW ROD	BWL ROD
3301087	BW ROD	NWL ROD
3300256	BW ROD	HWL ROD
3302160	BW ROD	BW CASING
3302165	BW ROD	NW CASING
3302170	BW ROD	HW CASING
3302155	BW ROD	HWT CASING
3301141	NW ROD	EW CASING
3300059	NW ROD	BWL ROD
3301086	NW ROD	NWL ROD
3301144	NW ROD	NRWL ROD
3301168	NW ROD	NW ROD
3301111	NW ROD	NWJ ROD
3302124	NW ROD	NW CASING
3302127	NW ROD	HWL ROD
3302128	NW ROD	HW CASING
3302156	NW ROD	HWT CASING
3301196	NWJ ROD	NWL ROD
3302135	HW CASING	4" NPT ROD



DCDMA ADAPTER SUBS

BOX X BOX		
PART #	BOX	BOX
3301060	AW ROD	N 4THD
3301090	AW ROD	2 3/8" API REG
3301260	AW ROD	3 1/2" API REG
3301125	AWJ ROD	N 4THD
3301159	AWJ ROD	2 3/8" API REG
3301132	AWJ ROD	2 7/8" API REG
3302161	AWJ ROD	3 1/2" API REG
3302056	N 4THD	BWL ROD
3301048	N 4THD	NWL ROD
3301046	N 4THD	NW ROD
3301150	NW ROD	2 3/8" API REG
3301210	NW ROD	3 1/2" API REG
3301211	NW ROD	NWL ROD
3301008	NWJ ROD	N 4THD
3301076	NWJ ROD	2 3/8" API REG
3301062	NWJ ROD	2 7/8" API REG
3301140	NWJ ROD	3 1/2" API REG
3301019	NWJ ROD	4 1/2" API REG
3301247	NWJ ROD	6 5/8" API REG
3301203	NWL ROD	2" NPT
3302011	NWL ROD	2 3/8" API REG
3300028	NWL ROD	2 7/8" API REG
3301154	HWL ROD	2 3/8" API REG
3300079	HWL ROD	2 7/8" API REG
3300057	HWT CASING	2 7/8" API REG
3302093	HWT CASING	3 1/2" API REG



API ADAPTER SUBS

API BOX X PIN		
PART #	BOX	PIN
3305050	1 1/4" NPT	AWJ
3301184	1 1/4" 7	AWJ
3301003	2 3/8" IF	2 3/8" REG
3301014	2 3/8" IF	3 1/2" REG
3301304	2 3/8" IF	NW ROD
3301016	2 3/8" IF	NWJ
3301013	2 3/8" IF	NWL
3302133	2 3/8" IF	HWL
3302075	2 3/8" IF	HWT CASING
3301151	2 3/8" REG	2 7/8" REG
3301152	2 3/8" REG	HWT CASING
3301189	2 3/8" MHJR	2 3/8" MHJR
3302026	2 3/8" MHJR	3 1/2" REG
3302040	2 3/8" MHJR	AWJ
3302047	2 3/8" MHJR	NWJ
3302015	2 3/8" MHJR	NWL
3301250	2 3/8" MHJR	HWL
3302016	2 3/8" MHJR	HW CASING
3302023	2 7/8" IF	2 3/8" IF
3305077	2 7/8" REG	2 3/8" REG
3300034	2 7/8" REG	NWJ
3301255	2 7/8" IF	HWL
3300111	3 1/2" REG	2 3/8" IF
3305062	3 1/2" REG	3 1/2" IF
3300036	4 1/2" REG	2 3/8" IF
3305068	4 1/2" REG	2 7/8" REG
3301041	7 5/8" REG	6 5/8" REG

API PIN X PIN		
PART #	BOX	PIN
3301164	2 3/8" IF	2 7/8" REG
3300120	2 3/8" REG	2 3/8" REG
3305079	2 3/8" MJR	NWJ
3302081	2 3/8" MHJR	2 3/8" MHJR
3301036	3 1/2" REG	3 1/2" REG



API ADAPTER SUBS

API BOX X BOX		
PART #	BOX	BOX
3300101	1 1/4" 7	AW
3301120	2 3/8" IF	2 7/8" REG
3305061	2 3/8" IF	3 1/2" REG
3301171	2 3/8" REG	2 3/8" IF
3302025	2 3/8" REG	2 3/8" REG
3300115	2 3/8" REG	2 7/8" REG
3300155	2 3/8" REG	3 1/2" REG
3301156	2 3/8" REG	4 1/2" REG
3302030	2 3/8" REG	N4 ROD
3301153	2 3/8" REG	NWL
3301154	2 3/8" REG	HWL
3302207	2 3/8" REG	NW CASING
3301188	2 3/8" MHJR	2 3/8" REG
3301300	2 3/8" MHJR	3 1/2" REG
3302024	2 7/8" IF	3 1/2" REG
3300046	2 7/8" IF	4 1/2" REG
3301190	3 1/2" REG	3 1/2" REG
3300030	3 1/2" REG	4 1/2" REG
3300041	3 1/2" REG	6 5/8" REG
3300042	3 1/2" REG	7 5/8" REG
3302033	4 1/2" REG	NWJ



SONIC ADAPTER SUBS

Subs are available for adapting between multiple tooling sizes and thread profiles. Hole Products offers subs in a variety of sizes and styles for adapting between multiple tooling sizes and thread profiles. All subs are manufactured from the highest quality materials using the industry's most advanced manufacturing techniques.

Custom sizes, breakout profiles, and thread gauges available. Please contact your Hole Products representative for further assistance.



BOX X BOX		
PART #	BOX	BOX
6340049	3 1/2" HP90 RH BOX	2 3/8" API REG BOX
6340075	3 1/2" HP90 RH BOX	2 7/8" API REG BOX
6340080	3 1/2" HP90 RH BOX	3 1/2" API REG BOX
6340096	3 1/2" HP90 RH BOX	3 1/2" HP90 RH BOX
6340081	4 1/2" HP90 RH BOX	3 1/2" API REG BOX

BOX X PIN		
PART #	BOX	PIN
6340095	3 1/2" HP90 RH BOX	2 3/8" API PIN
3300053	3 1/2" HP90 RH BOX	3" NPT PIN
6340082	AWJ BOX	3 1/2" HP90 RH PIN
6340092	2 3/8" IF BOX	3 1/2" HP90 RH PIN
6340033	5 7/8" HP90 LH BOX	7 5/8" HP90 LH PIN
6340034	5 7/8" HP90 LH BOX	8 5/8" HP90 LH PIN

SONIC SAVER SUBS

Saver subs are screwed into the bottom of the flange adapter and onto the inner drill string. When rods are added to deepen the hole, the threads are unscrewed between the saver sub and the drill string. The connection between the flange adapter and saver sub is rarely used and suffers minimal wear; whereas the lower connection is commonly used and suffers the most wear. Saver subs are expendable and represent a small investment as compared to the flange adapter.

PIN X PIN (Saver Subs)		
PART #	PIN	PIN
6340091	3 1/2" HP90 RH PIN	2 3/8" IF PIN
6340031	3 1/2" HP90 RH PIN	3 1/2" HP90 PIN
6360260	3 1/2" HP90 RH PIN	4 1/2" HP90 PIN
6360265	3 1/2" HP90 RH PIN	4 1/2" ROUSSY PIN

SONIC CORE BARREL DRIVER SUBS

Core barrel driver subs are designed for attaching drill rods to the core barrel.

Hole Products offers core barrel driver subs in a variety of sizes and styles. All subs are manufactured from the highest quality materials using the industries most advanced manufacturing techniques.

Custom sizes, breakout profiles, and thread gauges available.

Please contact your Hole Products representative for additional details.



BOX X PIN		
PART #	BOX	PIN
6340159	2 3/8" MHJR	3 1/2" HP90
6360400	2 3/8" IF	3 1/2" HP90
6340163	2 3/8" IF	4 1/2" HP90
6360420	2 3/8" IF	6" HP90
6360405	2 3/8" IF	7 5/8" HP90
6360410	2 3/8" IF	8 5/8" HP90
6340032	3 1/2" HP90	4 1/2" HP90
6340061	3 1/2" HP90	6" HP90
6360415	3 1/2" HP90	7 5/8" HP90
6360290	3 1/2" HP90	8 5/8" HP90
6360300	4 1/2" ROUSSY	4 1/2" HP90
6360305	4 1/2" ROUSSY	6" HP90
6360425	4 1/2" ROUSSY	7 5/8" HP90
6360310	4 1/2" ROUSSY	8 5/8" HP90

BOX X BOX (Split Barrel Subs)		
PART #	BOX	BOX
6340161	2 3/8" IF	4 1/2" HP90
6340155	3 1/2" HP90	4 1/2" HP90
6340156	4 1/2" ROUSSY	4 1/2" HP90

AUGER ADAPTERS

Hole Products offers a large selection of quality auger adapters in hex sizes ranging from 13/16" through 2". Additional adapters including hex x round bar and custom designs are available on request.

HEX PIN X HEX BOX					
PIN		BOX			
IN	MM	13/16"	1 1/8"	1 5/8"	2"
1 1/8"	29	1250790	1250805	1250815	1250820
1 5/8"	41	1250795	1250075	1250076	1250027
2"	51	1250800	1250810	1250166	1250825

HEX BOX X HEX BOX					
BOX		BOX			
IN	MM	13/16"	1 1/8"	1 5/8"	2"
1 1/8"	29	1250830	1250840	1250855	1250870
1 5/8"	41	1250144	1250845	1250860	1251015
2"	51	1250835	1250850	1250865	1250875



HEX BOX X ROD BOX				
HEX BOX		ROD BOX		
IN	MM	N3	NW	NWJ
1 1/8"	29	3301047	3300044	3301410
1 5/8"	41	3301415	3300039	3301099
2"	51	3301420	3301425	3301430

HEX PIN X ROD PIN			
HEX PIN		ROD PIN	
IN	MM	AWJ	NWJ
1 1/8"	29	3301061	3301435
1 5/8"	41	3300141	3301134
2"	51	3301440	3301445



REVERSE CIRCULATION SUBS

Hole Products offers a wide range of reverse circulation subs. All subs are manufactured using premium alloys and the most advanced manufacturing techniques, to maximize performance and durability. Reverse Circulation subs are available in a variety of sizes and with all industry standard thread connections. Our standard sub offering includes saver subs, adapter subs, cross-over subs, and bit subs. Custom subs are also available to meet all reverse circulation system requirements.